



landscape architecture\_horticulture  
environmentally sustainable design  
place making\_3D realisation

PO Box 510, Rozelle, NSW, 2039, Australia  
mob: 0412175439  
email: rupert@carmichaelstudios.com.au

project

28 YARRUNGA STREET, PRESTONS

28 YARRUNGA STREET, PRESTONS, NSW

client

FAVELLE FAVCO PTY LTD

DEVELOPMENT APPLICATION DRAWINGS

LD-SK-00 Landscape Site Plan Stage 01 \_rev F  
LD-SK-01 Landscape Planting Plan Ground Floor Stage 02 \_rev F



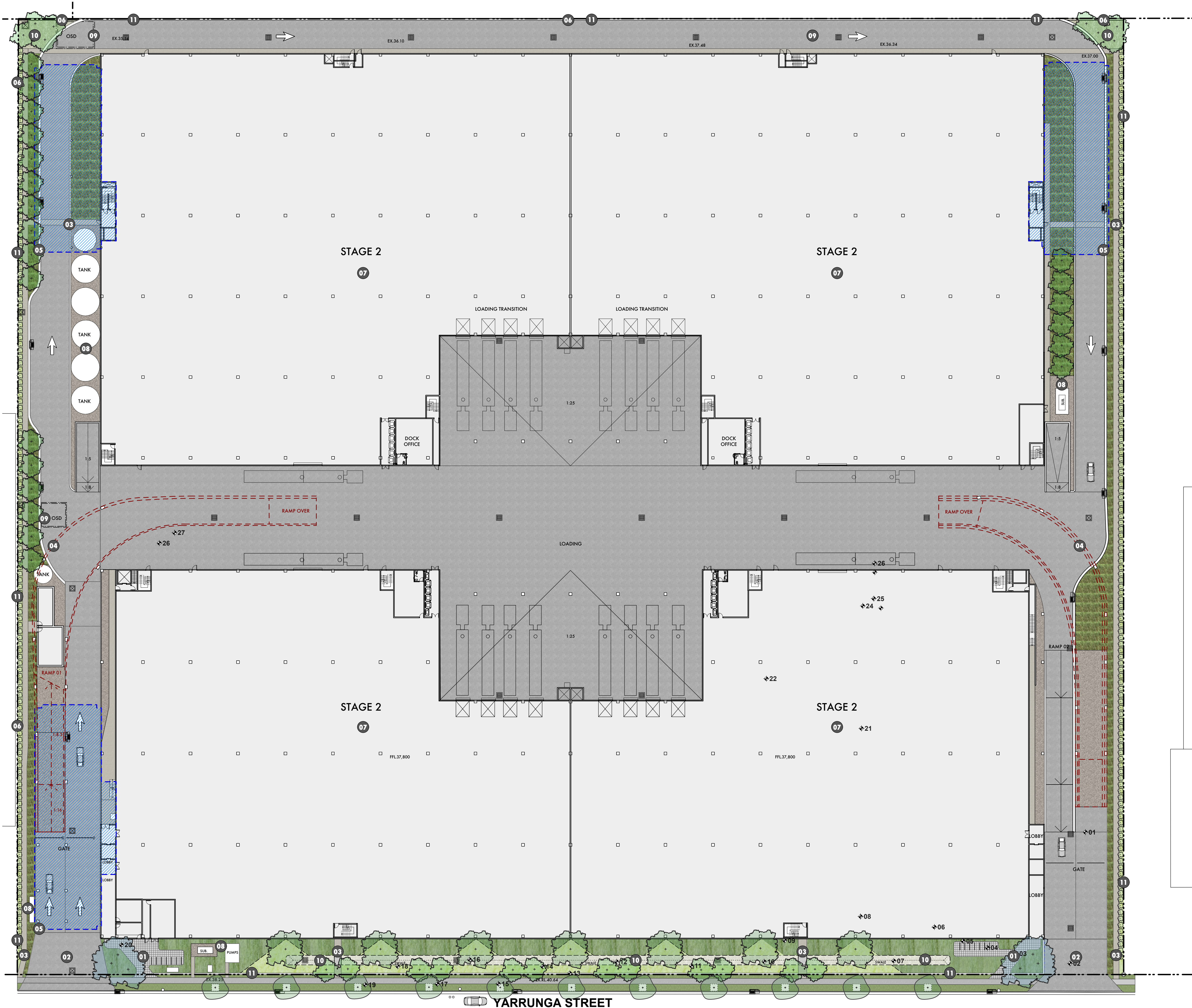

- LEGEND**
- SITE BOUNDARY
  - ROOF LINE ABOVE
  - + FL 13.60 PROPOSED FINISHED LEVEL
  - + FFL 13.60 PROPOSED INTERNAL FINISHED FLOOR LEVEL
  - + EL 13.60 EXISTING LEVEL
  - PROPOSED BOUNDARY WALL TO ARCH. DETAIL
  - PROPOSED STEEL EDGE DIVIDER TO LAWN/PLANTING AREA
  - ENTRY BIKE PARKING RAILS TO ARCH. DETAIL
  - DRAINAGE. REFER TO HYDRAULIC ENG. DRAWINGS FOR DETAIL
- PROGRAM/NOTES**
- 01 PROPOSED PEDESTRIAN ENTRY THRESHOLD TO ARCH. DETAIL
  - 02 PROPOSED VEHICLE ENTRY TO TRAFFIC. ENG. DETAIL
  - 03 INTERNAL PEDESTRIAN ACCESS PATH TO ARCH. DETAIL
  - 04 VEHICLE ENTRY RAMP ABOVE SHOWN DOTTED TO ARCH. DETAIL
  - 05 OFFICE SUITES ABOVE SHOWN DOTTED TO ARCH. DETAIL
  - 06 PROPOSED BOUNDARY WALL TO CIVIL ENG. DETAIL
  - 07 GROUND FLOOR PARKING. TO TRAFFIC. ENG. DETAIL
  - 08 GROUND FLOOR SERVICES AND TANKS. TO ARCH. DETAIL
  - 09 RAINWATER TANK BELOW SHOWN DOTTED. TO HYD.ENG. DETAIL
  - 10 PLANTED SWALE/RAINGARDEN/BIOFILTRATION LANDSCAPE
  - 11 1.8M HIGH CHAIN FENCE TO EAST, WEST AND NORTH BOUNDARY. 1.8M PALISADE FENCE TO FRONT SOUTH BOUNDARY. TO ARCH DETAIL
- MATERIALS**
- VEHICLE ENTRY TO ARCH. DETAIL
  - SITE INSITU CONCRETE PEDESTRIAN PATH TO ARCH. DETAIL
  - INSITU CONCRETE PUBLIC PEDESTRIAN PATH TO COUNCIL REQUIREMENTS
  - PROPOSED PAVED PEDESTRIAN ENTRY PATH/THRESHOLD TO ARCH. DETAIL
  - 50MM DEPTH 40-75MM DIA AGGREGATE AS FINISHED SURFACE AT GRADE
- PLANTING**
- SOUTHERN ENTRY BOUNDARY PROPOSED NATIVE PLANTING MIX TYPE 01 AT GRADE IN MINIMUM 300MM GARDEN SOIL MIX
  - SOUTHERN ENTRY BOUNDARY PROPOSED NATIVE PLANTING MIX TYPE 02 AT GRADE IN MINIMUM 300MM GARDEN SOIL MIX
  - SOUTHERN INTERNAL PROPOSED NATIVE PLANTING MIX TYPE 03 AT GRADE IN MINIMUM 300MM GARDEN SOIL MIX
  - NATIVE 'RAIN GARDEN' /SWALE PLANTING MIX TYPE 04 AT GRADE IN MINIMUM 300MM BIOFILTRATION SOIL MIX
  - PROPOSED LAWN AT GRADE TO PUBLIC VERGE TO COUNCIL REQUIREMENTS
  - PROPOSED SHRUB, GRASS AND GROUND COVER PLANTING AT GRADE
  - PROPOSED NATIVE TREE PLANTING AT GRADE
  - PROPOSED STREET TREE PLANTING TO BE CONFIRMED BY LIVERPOOL COUNCIL PRIOR TO CONSTRUCTION DOCUMENTATION
  - EXISTING TREES TO BE REMOVED. REFER TO ARBORIST REPORT FOR DETAIL

note: information on existing trees refer to arborist report note: DRAWINGS PREPARED FOR DEVELOPMENT APPLICATION ONLY. NOT TO BE USED FOR CONSTRUCTION.

- NOTES**
- 01: STAKING\_ All tree staking to comply with Liverpool Council requirements and Australian Standards.
- 02: SOIL PREPARATION\_ All imported soil mixes are to conform to AS4419, AS 1289-4, AS 3743, AS4419, AS4454. For at grade planting, mix of least 300mm soil depth to planting areas to allow for finish to design levels as nominated. Imported fill to be clean fill free of extraneous material and weed species. 300mm deep soil mix to be 200mm depth of good quality organic planting mix (A.N.I or approved equivalent) to be imported and combined with 100mm depth A.N.I Greenville compost or approved equivalent. All soil to be free of weed species and ongoing weed management procedures. Light weight garden soil mixes are to be used for on structure planting. This soil mix is to consist of two light weight mixes: on upper layer (horizon A) of 300mm and a lower layer (horizon B). Material will have the general properties conforming to AS 4419 for a 'natural soil'.
- 03: SITE PREPARATION\_ Existing trees and vegetation to be retained shall be preserved and protected from damage during the execution of landscape work. Root systems of existing plants must not be disturbed if possible. Any site works adjacent the tree protection zone (TPZ) should be carried out using hand tools. Vehicle access shall not be permitted within [3] metres of any tree. Refer to arborist report for detail.
- 04: MULCH\_ All planting areas to be mulched with a minimum 75mm thick cover of 'Forest Finest' mulch or similar approved. All mulched areas to be thoroughly soaked with water and to be free of all weed species.
- 05: FERTILISER\_ All planting areas to be fertilised with 9 month 'NPK' slow release fertiliser.
- 06: PLANTING\_ Planting holes for plant material should be large enough in size to take root ball with additional space to take back filling of good quality planting mix. Mature heights of proposed planting shown on planting plan show the height possible in ideal conditions. These heights are subject to particular site conditions, possible container environments and intended hedging or pruning for functional requirements such as available planting width, intended access under branches and solar access.
- 07: IRRIGATION\_ Automatic irrigation watering system to be selected for all landscape areas. Install pumps, filters and all other necessary fittings to operate system. Irrigation system to conform with all Water Board, Liverpool Council and Australian Standards [AS]. All irrigation to be in ground dripline system.
- 08: MAINTENANCE\_ The Landscape Contractor shall maintain the contract site to accepted horticultural practices as well as rectifying any defects during the establishment period. Work shall comply with the following Standards to the extent that they are relevant: SA-H89 Occupational Personal Protection, AS3765 Clothing for protection against hazardous chemicals, AS4373 Pruning of Amenity Trees, AS 3743 Paving mixes, AS 4419 Soils for landscaping and garden use, AS 4454 Composts, soil conditioners and mulches, AS 1289-4 Soil chemical testing, AS/NZS 5607 Water Quality - Sampling. The Landscape Contractor shall maintain the works during the establishment period and make good all defects for a minimum period of Thirteen [13] weeks after the date of practical completion. The period shall commence immediately after the installation of the plant material and continue for the duration specified above. Practical completion of the landscape works shall include but not be limited to the replacement of plants which have failed or been damaged or stolen during work under the contract. Landscape maintenance shall include but not be limited to the following: watering, rubbish removal, spraying and weeding leaf surfaces, replacing failed plants, maintaining mulch, pruning, insect and disease control, cleaning of surrounding areas. Submit a maintenance program for the works prior to commencement. Amend program as required until approved.
- 09: GENERAL\_ All existing and proposed levels to be checked on site and confirmed with builder supervisor/landscape contractor prior to construction commencement. All existing landscape element locations to be checked on site and confirmed with builder supervisor or landscape architect prior to construction commencement. Position of all services on site to be confirmed prior to construction commencement.
- DRAWINGS PREPARED FOR DEVELOPMENT APPLICATION ONLY. NOT TO BE USED FOR CONSTRUCTION.

28 YARRUNGA STREET  
FAVELLE FAVCO PTY. LTD

LANDSCAPE SITE PLAN STAGE 02  
DEVELOPMENT APPLICATION [NOT FOR CONSTRUCTION]\_28 YARRUNGA STREET, PRESTONS, NSW, AUSTRALIA

SK 01  
CARMICHAEL STUDIOS

REVISION F  
1:400 @ A1\_50% @ A3

PO Box 510, Rozelle, NSW, 2039, Australia  
mob: 0412175439  
email: ruper@carmichaelstudios.com.au





CORYMBIA GUMMIFERA EUCALYPTUS CREBRA TRISTANIOPSIS LAURINA MELALEUCA DECORA ACMINA SMITHII x MINOR WESTRINGEA 'MUNDI' BURSARIA SPINOSA GREVILLEA 'MOLONGOLO' GOODENIA HEDERACEA HIBBERTIA SCANDENS HARDENBERGIA VIOLACEA ISOLEPSIS NODOSA THEMEDA TRIANDRA DIANELLA 'SILVER STREAK' DIANELLA CAERULEA LOMANDRA 'TANIKA'

75L [mature height 8m]  
Melaleuca decora  
04no.  
150mm [mature height 500mm]  
Isoplepis nodosa  
105no.  
150mm [mature height 500mm]  
Juncus flavidus  
105no.  
150mm [scrambler 300mm]  
Hardenbergia violacea  
45no.  
NOTE: native planting MATRIX TYPE 04. Plant shrubs and ground covers in minimum groups x 03. Plant sedges and grasses in minimum groups of 07. Approximate planting area [45m2]

75L [mature height 5-10m]  
Tristanopsis laurina  
10no.  
150mm [mature height 3-5m]  
Bursaria spinosa  
85no.  
150mm [mature height 800mm]  
Grevillea 'Molongolo'  
85no.  
150mm [mature height 1.5m]  
Lomandra longifolia  
105no.  
150mm [mature height 500mm]  
Lomandra 'Tanika'  
105no.  
150mm [mature height 800mm]  
Dianella caerulea  
105no.  
150mm [mature height 800mm]  
Themeda triandra  
105no.  
150mm [scrambler 300mm]  
Hibbertia scandens  
85no.  
NOTE: native planting MATRIX TYPE 03. Plant shrubs and ground covers in minimum groups x 03. Plant sedges and grasses in minimum groups of 07. Approximate planting area [260m2]

75L [mature height 5-10m]  
Tristanopsis laurina  
06no.  
150mm [mature height 3-5m]  
Bursaria spinosa  
85no.  
150mm [mature height 800mm]  
Grevillea 'Molongolo'  
85no.  
150mm [mature height 1.5m]  
Lomandra longifolia  
105no.  
150mm [mature height 500mm]  
Lomandra 'Tanika'  
105no.  
150mm [mature height 800mm]  
Dianella caerulea  
105no.  
150mm [mature height 800mm]  
Themeda triandra  
105no.  
150mm [scrambler 300mm]  
Hibbertia scandens  
85no.

150mm [mature height 5m]  
Acmena smithii x minor  
140no.  
150mm [mature height 500mm]  
Lomandra 'Tanika'  
300no.  
150mm [mature height 500mm]  
Dianella 'Silver Streak'  
300no.  
150mm [mature height 800mm]  
Goodenia hederacea  
90no.  
150mm [scrambler 300mm]  
Hardenbergia violacea  
90no.

NOTE: native planting MATRIX TYPE 02. Plant shrubs and ground covers in minimum groups x 03. Plant sedges and grasses in minimum groups of 07. Approximate planting area [180m2]

150mm [mature height 500mm]  
Isoplepis nodosa  
620no.  
150mm [mature height 500mm]  
Juncus flavidus  
620no.  
150mm [scrambler 300mm]  
Hardenbergia violacea  
270no.

NOTE: native planting MATRIX TYPE 04. Plant shrubs and ground covers in minimum groups x 03. Plant sedges and grasses in minimum groups of 07. Approximate planting area [270m2]

100L [mature height 25m]  
Eucalyptus crebra  
03no.

NOTE: PROPOSED STREET TREE PLANTING REQUIREMENTS TO BE CONFIRMED BY LIVERPOOL COUNCIL PRIOR TO CONSTRUCTION DOCUMENTATION

PROPOSED NATIVE PLANTING SCHEDULE			
BOTANICAL NAME	COMMON NAME	CONTAINER SIZE	NO.
TREES			
* Corymbia gummifera	Blood Wood	100L	07
* Eucalyptus crebra	Narrow-leaf Ironbark	100L	06
Tristanopsis laurina	Water gum	75L	41
Melaleuca decora	Paperbark	75L	08
SHRUBS			
Acmena smithii x minor	Small Leafed Lillypilly	150mm	180
Westringea 'Mundi'	Coastal Rosemary	150mm	190
* Bursaria spinosa	Blackthorn	150mm	400
* Grevillea 'Molongolo'	Juniperina 'Molongolo'	150mm	590
* Goodenia hederacea	Goodenia	150mm	395
GROUNDCOVERS/GRASSES			
* Themeda triandra	Kangaroo Grass	150mm	785
* Lomandra 'Tanika'	Mat-rush 'Tanika'	150mm	2390
Dianella 'Silver Streak'	'Silver Streak'	150mm	1605
* Dianella caerulea	Flax Lily	150mm	1735
* Lomandra longifolia	Spiny Mat-rush	150mm	1735
Juncus flavidus	Common Rush	150mm	830
Isoplepis nodosa	Club Rush	150mm	830
CLIMBERS/SCRAMBLERS			
* Hardenbergia violacea	Happy Wanderer	150mm	755
Hibbertia scandens	Guinea Flower	150mm	590

NOTE: \* Cumberland Plains Woodland Species - Cultivars

75L [mature height 8m]  
Melaleuca decora  
04no.  
150mm [mature height 500mm]  
Isoplepis nodosa  
105no.  
150mm [mature height 500mm]  
Juncus flavidus  
105no.  
150mm [scrambler 300mm]  
Hardenbergia violacea  
45no.  
NOTE: native planting MATRIX TYPE 04. Plant shrubs and ground covers in minimum groups x 03. Plant sedges and grasses in minimum groups of 07. Approximate planting area [45m2]

75L [mature height 5-10m]  
Tristanopsis laurina  
13no.  
150mm [mature height 3-5m]  
Bursaria spinosa  
230no.  
150mm [mature height 800mm]  
Grevillea 'Molongolo'  
230no.  
150mm [mature height 1.5m]  
Lomandra longifolia  
575no.  
150mm [mature height 500mm]  
Lomandra 'Tanika'  
575no.  
150mm [mature height 800mm]  
Dianella caerulea  
575no.  
150mm [mature height 800mm]  
Themeda triandra  
575no.  
150mm [scrambler 300mm]  
Hibbertia scandens  
230no.  
NOTE: native planting MATRIX TYPE 03. Plant shrubs and ground covers in minimum groups x 03. Plant sedges and grasses in minimum groups of 07. Approximate planting area [714m2]

150mm [mature height 5m]  
Acmena smithii x minor  
140no.  
150mm [mature height 500mm]  
Lomandra 'Tanika'  
325no.  
150mm [mature height 500mm]  
Dianella 'Silver Streak'  
325no.  
150mm [mature height 800mm]  
Goodenia hederacea  
95no.  
150mm [scrambler 300mm]  
Hardenbergia violacea  
95no.  
NOTE: native planting MATRIX TYPE 02. Plant shrubs and ground covers in minimum groups x 03. Plant sedges and grasses in minimum groups of 07. Approximate planting area [195m2]

75L [mature height 5-10m]  
Tristanopsis laurina  
12no.  
150mm [mature height 500mm]  
Lomandra 'Tanika'  
980no.  
150mm [mature height 500mm]  
Dianella 'Silver Streak'  
980no.  
150mm [mature height 800mm]  
Goodenia hederacea  
210no.

150mm [scrambler 300mm]  
Hardenbergia violacea  
210no.  
NOTE: native planting MATRIX TYPE 02. Plant shrubs and ground covers in minimum groups x 03. Plant sedges and grasses in minimum groups of 07. Approximate planting area [417m2]

100L [mature height 15m]  
Corymbia gummifera  
07no.  
150mm [mature height 0.5m]  
Westringea 'Mundi'  
190no.  
150mm [mature height 800mm]  
Grevillea 'Molongolo'  
190no.  
150mm [mature height 1.5m]  
Lomandra longifolia  
950no.  
150mm [mature height 800mm]  
Dianella caerulea  
950no.  
150mm [scrambler 300mm]  
Hibbertia scandens  
190no.

NOTE: native planting MATRIX TYPE 01. Plant shrubs in minimum groups x 03. Plant sedges and grasses in minimum groups of 07. Approximate planting area [580m2]

100L [mature height 25m]  
Eucalyptus crebra  
03no.

- LEGEND
- SITE BOUNDARY
  - - - ROOF LINE ABOVE
  - + FL 13.60 PROPOSED FINISHED LEVEL
  - + FFL 13.60 PROPOSED INTERNAL FINISHED FLOOR LEVEL
  - + EL 13.60 EXISTING LEVEL
  - PROPOSED BOUNDARY WALL TO ARCH. DETAIL
  - - - PROPOSED STEEL EDGE DIVIDER TO LAWN/PLANTING AREA
  - ||| ENTRY BIKE PARKING RAILS TO ARCH. DETAIL
  - DRAINAGE. REFER TO HYDRAULIC ENG. DRAWINGS FOR DETAIL
- PROGRAM/NOTES
- 01 PROPOSED PEDESTRIAN ENTRY THRESHOLD TO ARCH. DETAIL
  - 02 PROPOSED VEHICLE ENTRY TO TRAFFIC. ENG. DETAIL
  - 03 INTERNAL PEDESTRIAN ACCESS PATH TO ARCH. DETAIL
  - 04 VEHICLE ENTRY RAMP ABOVE SHOWN DOTTED TO ARCH. DETAIL
  - 05 OFFICE SUITES ABOVE SHOWN DOTTED TO ARCH. DETAIL
  - 06 PROPOSED BOUNDARY WALL TO CIVIL ENG. DETAIL
  - 07 GROUND FLOOR PARKING. TO TRAFFIC. ENG. DETAIL
  - 08 GROUND FLOOR SERVICES AND TANKS. TO ARCH. DETAIL
  - 09 RAINWATER TANK BELOW SHOWN DOTTED. TO HYD.ENG. DETAIL
  - 10 PLANTED SWALE/RAIN GARDEN/BIOFILTRATION LANDSCAPE
  - 11 1.8M HIGH CHAIN FENCE TO EAST, WEST AND NORTH BOUNDARY. 1.8M PALISADE FENCE TO FRONT SOUTH BOUNDARY. TO ARCH DETAIL

- MATERIALS
- VEHICLE ENTRY TO ARCH. DETAIL
  - SITE INSTU CONCRETE PEDESTRIAN PATH TO ARCH. DETAIL
  - INSTU CONCRETE PUBLIC PEDESTRIAN PATH TO COUNCIL. REQUIREMENTS
  - PROPOSED PAVED PEDESTRIAN ENTRY PATH/THRESHOLD TO ARCH. DETAIL
  - 50MM DEPTH 40-75MM DIA AGGREGATE AS FINISHED SURFACE AT GRADE
- PLANTING
- SOUTHERN ENTRY BOUNDARY PROPOSED NATIVE PLANTING MIX TYPE 01 AT GRADE IN MINIMUM 300MM GARDEN SOIL MIX
  - SOUTHERN ENTRY BOUNDARY PROPOSED NATIVE PLANTING MIX TYPE 02 AT GRADE IN MINIMUM 300MM GARDEN SOIL MIX
  - SOUTHERN INTERNAL PROPOSED NATIVE PLANTING MIX TYPE 03 AT GRADE IN MINIMUM 300MM GARDEN SOIL MIX
  - NATIVE 'RAIN GARDEN'/SWALE PLANTING MIX TYPE 04 AT GRADE IN MINIMUM 300MM BIOFILTRATION SOIL MIX
  - PROPOSED LAWN AT GRADE TO PUBLIC VERGE TO COUNCIL. REQUIREMENTS
  - PROPOSED SHRUB, GRASS AND GROUND COVER PLANTING AT GRADE
  - PROPOSED NATIVE TREE PLANTING AT GRADE
  - PROPOSED STREET TREE PLANTING TO BE CONFIRMED BY LIVERPOOL COUNCIL PRIOR TO CONSTRUCTION DOCUMENTATION
  - EXISTING TREES TO BE REMOVED. REFER TO ARBORIST REPORT FOR DETAIL

note: information on existing trees refer to arborist repo note: DRAWINGS PREPARED FOR DEVELOPMENT APPLICATION ONLY. NOT TO BE USED FOR CONSTRUCTION.

- NOTES
- 01: STAKING\_ All tree staking to comply with Liverpool Council requirements and Australian Standards.
  - 02: SOIL PREPARATION\_ All imported soil mixes are to conform to AS4419, AS 1289-4, AS 3743, AS4419, AS4454. For at grade planting, mix of least 300mm soil depth to planting areas to allow for finish to design levels as nominated. Imported fill to be clean fill free of extraneous material and weed species. 300mm deep soil mix to be 200mm depth of good quality organic planting mix [A.N.I. or approved equivalent] to be imported and combined with 100mm depth A.N.I. Greenville compost or approved equivalent. All soil to be free of weed species and ongoing weed management procedures. Light weight garden soil mixes are to be used for on structure planting. This soil mix is to consist of two light weight mixes: on upper layer (horizon A) of 300mm and a lower layer (horizon B). Material will have the general properties conforming to AS 4419 for a 'natural soil'.
  - 03: SITE PREPARATION\_ Existing trees and vegetation to be retained shall be preserved and protected from damage during the execution of landscape work. Root systems of existing plants must not be disturbed if possible. Any site works adjacent the tree protection zone [TPZ] should be carried out using hand tools. Vehicle access shall not be permitted within [3] metres of any tree. Refer to arborist report for detail.
  - 04: MULCH\_ All planting areas to be mulched with a minimum 75mm thick cover of 'Forest Fines' mulch or similar approved. All mulched areas to be thoroughly soaked with water and to be free of all weed species.
  - 05: FERTILISER\_ All planting areas to be fertilised with 9 month 'NPK' slow release fertiliser.
  - 06: PLANTING\_ Planting holes for plant material should be large enough in size to take root ball with additional space to take back filling of good quality planting mix. Mature heights of proposed planting shown on planting plan show the height possible in ideal conditions. These heights are subject to particular site conditions, possible container environments and intended hedging or pruning for functional requirements such as available planting width, intended access under branches and solar access.
  - 07: IRRIGATION\_ Automatic irrigation watering system to be selected for all landscape areas. Install pumps, filters and all other necessary fittings to operate system. Irrigation system to conform with all Water Board, Liverpool Council and Australian Standards [AS]. All irrigation to be in ground drip line system.
  - 08: MAINTENANCE\_ The Landscape Contractor shall maintain the contract site to accepted horticultural practices as well as rectifying any defects during the establishment period. Work shall comply with the following Standards to the extent that they are relevant: SA HSP Occupational Personal Protection, AS3765 Clothing for protection against hazardous chemicals, AS4373 Pruning of Amenity Trees, AS 3743 Planting mixes, AS 4419 Soils for landscaping and garden use, AS 4454 Composts, soil conditioners and mulches, AS 1289-4 Soil chemical testing, AS/NZS 5607 Water Quality - Sampling. The landscape Contractor shall maintain the works during the establishment period and make good all defects for a minimum period of Thirteen [13] weeks after the date of practical completion. The period shall commence immediately after the installation of the plant material and continue for the duration specified above. Practical completion of the landscape works shall include but not be limited to the replacement of plants which have failed or been damaged or stolen during work under the contract. Landscape maintenance shall include but not be limited to the following: watering, rubbish removal, spraying and wiping leaf surfaces, replacing failed plants, maintaining mulch, pruning, insect and disease control, cleaning of surrounding areas. Submit a maintenance program for the works prior to commencement. Amend program as required until approved.
  - 09: GENERAL\_ All existing and proposed levels to be checked on site and confirmed with builder supervisor/landscape contractor prior to construction commencement. All existing landscape element locations to be checked on site and confirmed with builder supervisor or landscape architect prior to construction commencement. Position of all services on site to be confirmed prior to construction commencement.
- DRAWINGS PREPARED FOR DEVELOPMENT APPLICATION ONLY. NOT TO BE USED FOR CONSTRUCTION.

28 YARRUNGA STREET  
FAVELLE FAVCO PTY. LTD

LANDSCAPE PLANTING PLAN GROUND FLOOR STAGE 02  
DEVELOPMENT APPLICATION [NOT FOR CONSTRUCTION]\_28 YARRUNGA STREET, PRESTONS, NSW, AUSTRALIA

SK 02 CARMICHAEL STUDIOS  
PO Box 510, Roselle, NSW, 2039, Australia  
mob: 0412175439  
email: nuper@carmichaelstudios.com.au  
REVISION F  
1:500 @ A1, 50% @ A3